



ALL MY MOMMY'S
IMAGINARY FRIENDS
ARE ON SOMETHING
CALLED "FACEBOOK."

The Organisational Implications for Adopting e-Learning

John Clayton

Emerging Technology Centre



Wintec

WAIKATO INSTITUTE OF TECHNOLOGY

Te Kuratini o Waikato

Employees hold views of the world and meanings for words that make sense to them

Industry attempt to capture that knowledge and encloses it in a specific learning environment.

How the e-frame is constructed is crucial to fully engaging employees



Wintec
WAIKATO INSTITUTE OF TECHNOLOGY
Te Kuratini o Waikato

NZ population Internet use by individuals for education: 2006

Age Group	Recent Internet users	% of total population	Education or study
15 - 19		87.2	55.1
20 - 24		83.8	39.4
25 - 29	212,000	82.4	23.3
30 - 34	225,700	82.8	20.8
35 - 39	232,800	77.0	22.1
40 - 44	242,800	77.8	21.3
45 - 49	220,100	73.3	21.9
50 - 54	179,300	68.9	19.4
55 - 59	152,000	63.8	15.9
60 +	240,600	35.8	14.0
Total	2,207,600	69.0	26.3



Wintec

WAIKATO INSTITUTE OF TECHNOLOGY

Te Kuratini o Waikato

Ki te whakakaha i te iwi mā te ara mātauranga, te rangahau umanga whanakenga hoki

Statistics New Zealand. (2007). *Business Operations Survey: 2006*

Business use of computers and the Internet: 2006

Business Size	Total	% Using computers	% Using the Internet
6-19 employees	25,974	92	89
20-49 employees	6,288	97	95
50-99 employees	1,731	99	98
100+ employees	1,440	100	99



Wintec
 WAIKATO INSTITUTE OF TECHNOLOGY
 Te Kuratini o Waikato

Ki te whakakaha i te iwi mā te ara mātauranga, te rangahau umanga whanakenga hoki

Statistics New Zealand. (2007). *Business Operations Survey: 2006*

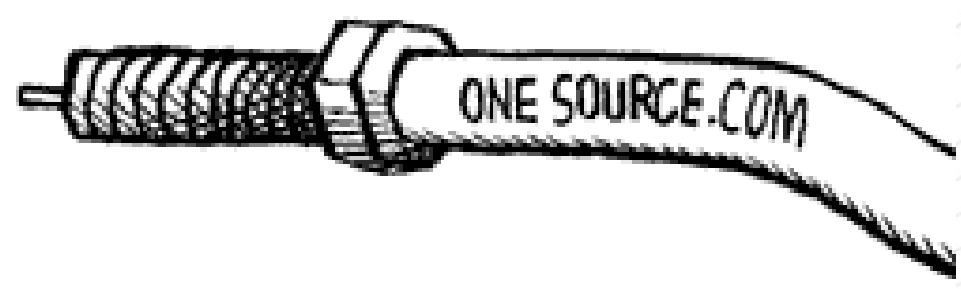
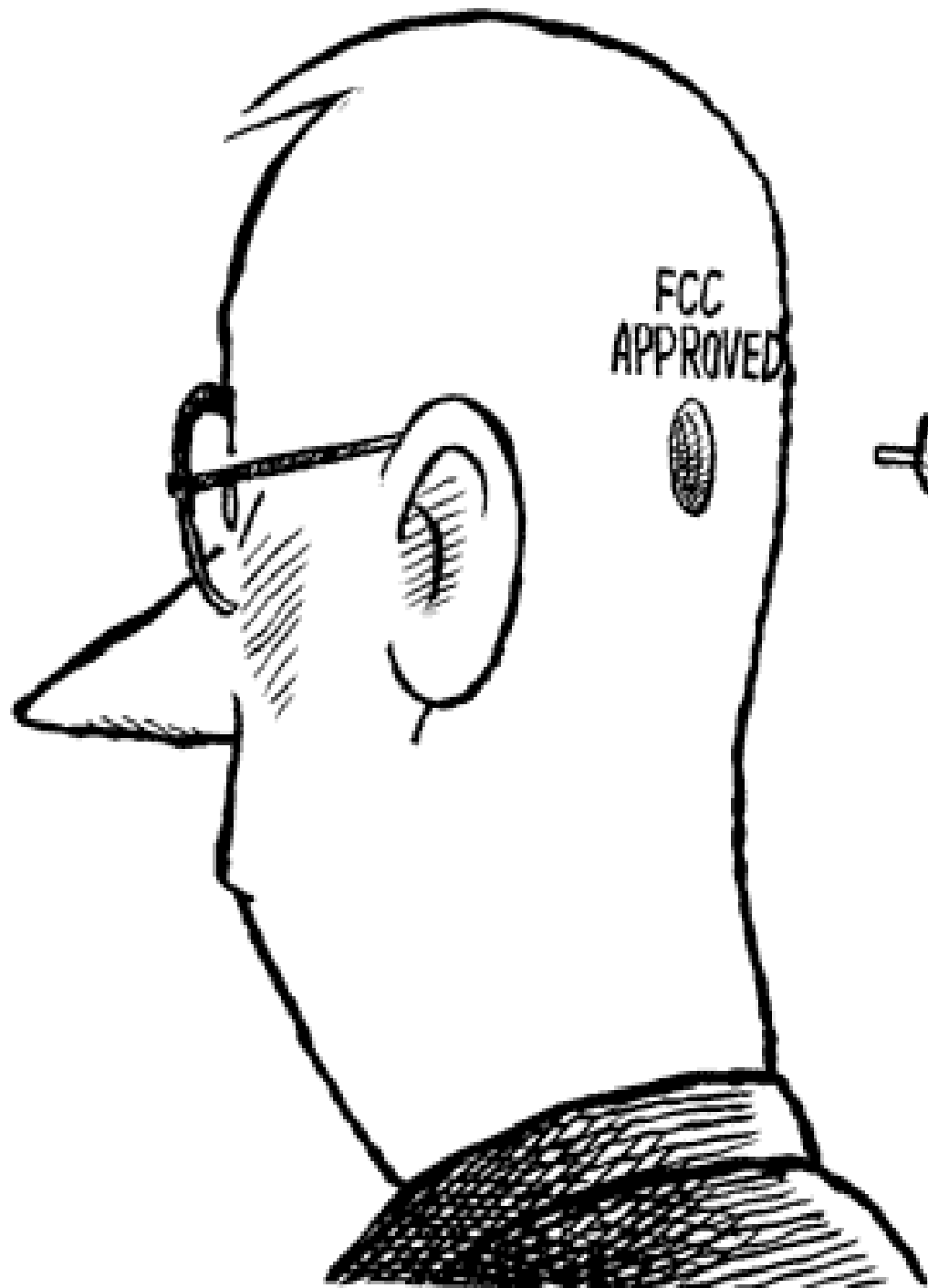

Information Overload

There is an ever “increasing amount of information” -organisational, individual, trade and professional – “employees need to be aware” of to complete their tasks successfully.



Wintec

WAIKATO INSTITUTE OF TECHNOLOGY

Te Kuratini o Waikato

Technological Innovation

The rapid rate of change in production, informational and communication technologies impacts on work practices and this impact needs to be managed in a consistent and timely manner.



Wintec

WAIKATO INSTITUTE OF TECHNOLOGY

Te Kuratini o Waikato

Return on Investment

The provision of training to improve performance at an individual and organisational level must be done economically and efficiently.



Wintec

WAIKATO INSTITUTE OF TECHNOLOGY

Te Kuratini o Waikato

2 Days of Classroom Training**Blended**

Training Component	Cost per Learner	Total Cost	Total Cost
Training, Design, Project Mgmt	\$250	\$250,000	\$50,000
Learner Materials	\$275	\$275,000	\$175,000
Facilitation Services	\$175	\$175,000	\$75,000
Travel/Accommodations/Meals	\$500	\$500,000	\$0
Sub-Total: Hard costs	\$1,200	\$1,200,000	\$300,000
Employee Time off the Job	\$800	\$800,000	\$400,000
Total Cost of Investment	\$2,000	\$2,000,000	\$700,000
Performance Improvement		2%	7%
Value of Increase in Productivity	(\$100k salary)	\$2,000,000	\$7,000,000
Return on Investment (ROI)		none	10x

DON'T WORRY. TECHNOLOGY
WILL SAVE YOU.



MUELLER

The e-learning Promise

e-learning is seen to be critical in providing

- the right skills training,
- to the right person,
- at the right time,
- in the right place.



Wintec

WAIKATO INSTITUTE OF TECHNOLOGY

Te Kuratini o Waikato

Technology
Enhanced
Education



Flexible
Learning

e-Learning

Computer
Based
Training



Pre-packaged
Delivery



Mobile
Learning



Ki te whakakaha i te iwi mā te ara mātau

hoki



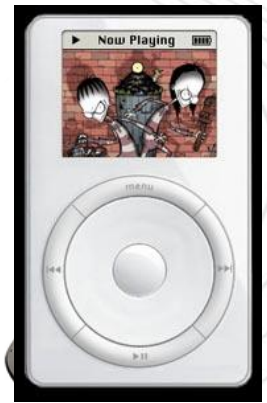

CAN'T YOU DO
ANYTHING RIGHT?



Making it Simple

- You are to buy a box of coloured pencils as a gift.
- Q1: What range of colours can you buy?
- Q2: Can each of the colours be described?



Wintec
WAIKATO INSTITUTE OF TECHNOLOGY
Te Kuratini o Waikato

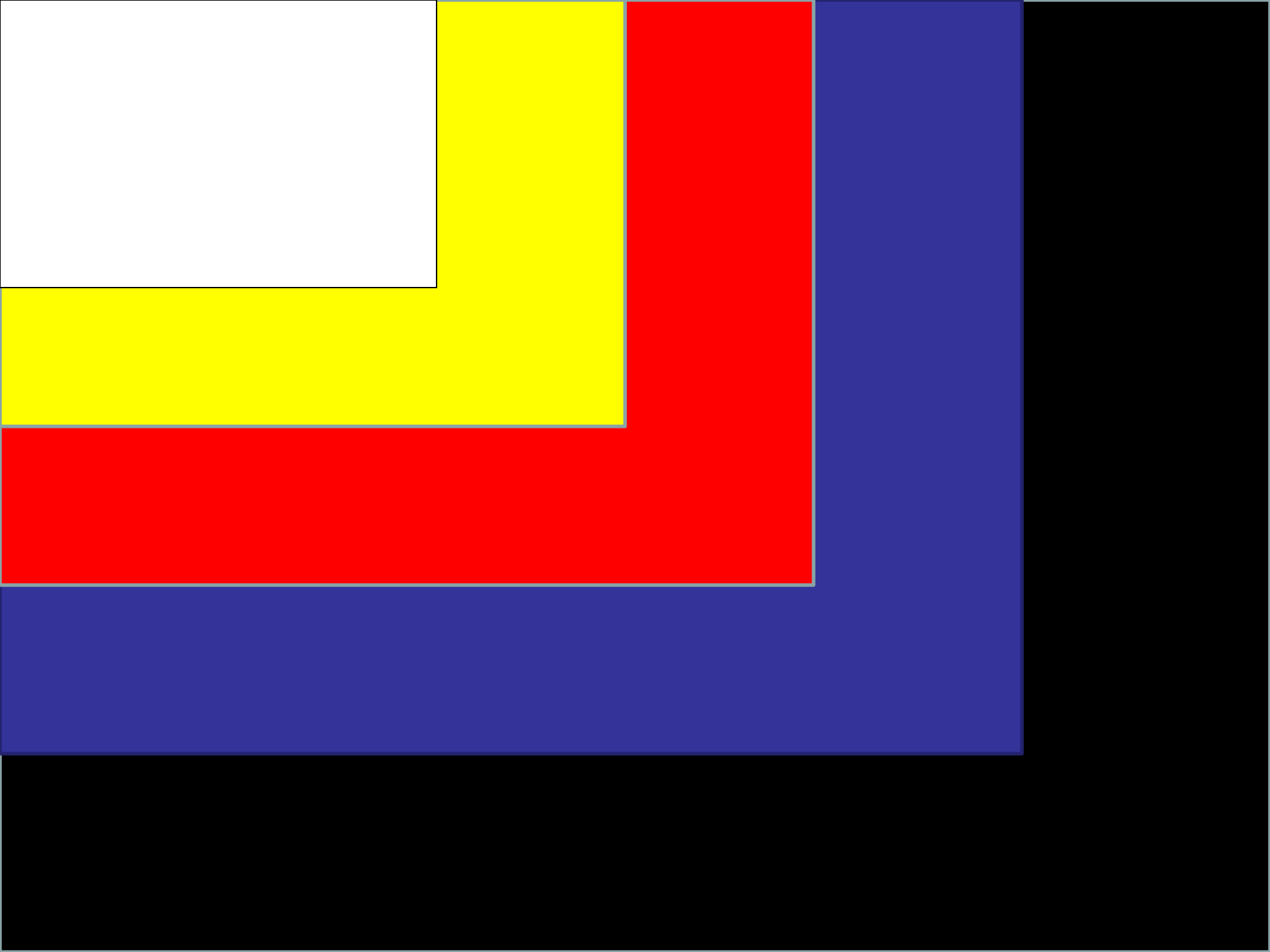

Accomplishment

Action

Awareness

Enabled



Context

Engaged



Content

Empowered

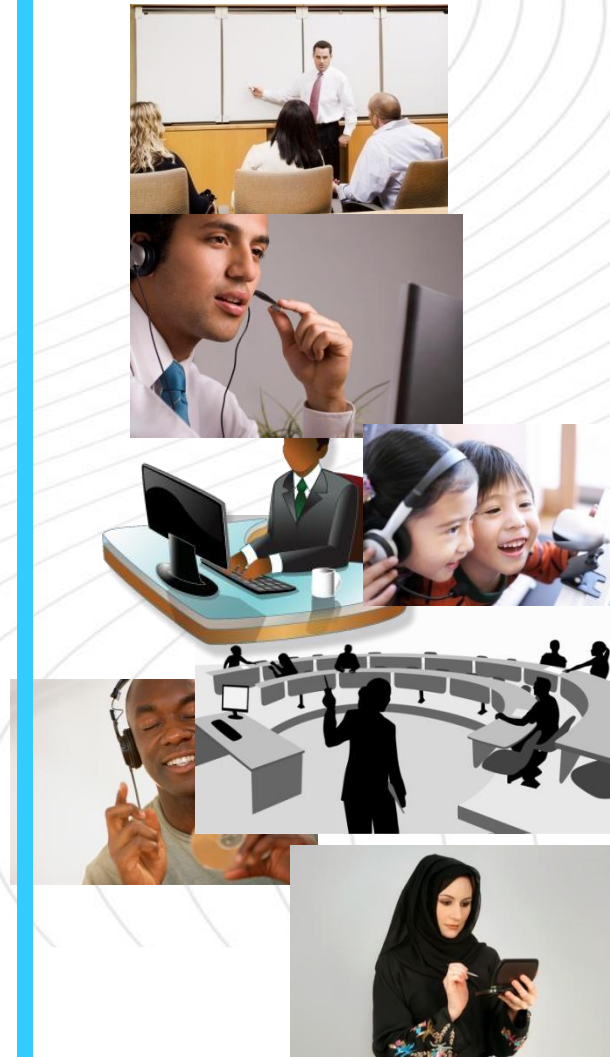

Capability

ICT Accomplishment (Measure)

Assess

Enabled

Connections are reliable and robust.

Access policies are designed to facilitate delivery of ICT facilitated teaching and learning events.

Purchase of peripheral devices and software are aligned with school policies and procedures

Context

Assess

Engaged

Learners are actively engaged with course resources deployed.

Digital learning objects are indexed, stored, retrieved and presented

Participants have access to course materials they need, when they need them

Content

Assess

Empowered

Teachers are provided with professional development in ICT enabling them to participate fully in ICT environments.

Learners provided with ongoing support enabling them to participate fully in ICT environments

Capability

Action

Action

Action

ICT Awareness (Plan)



wintec

Two Dimensional

- QR code is presented in both the vertical and horizontal dimension (direction) (2D)

QR Code: Wintec

DATA



DATA

Accomplishment

Assess

Enabled

Connections generated by codes are reliable and robust.



Infrastructure facilitates the transfer of information between disparate information platforms and systems to mobile devices.

Context

Action

Awareness

QuickMark

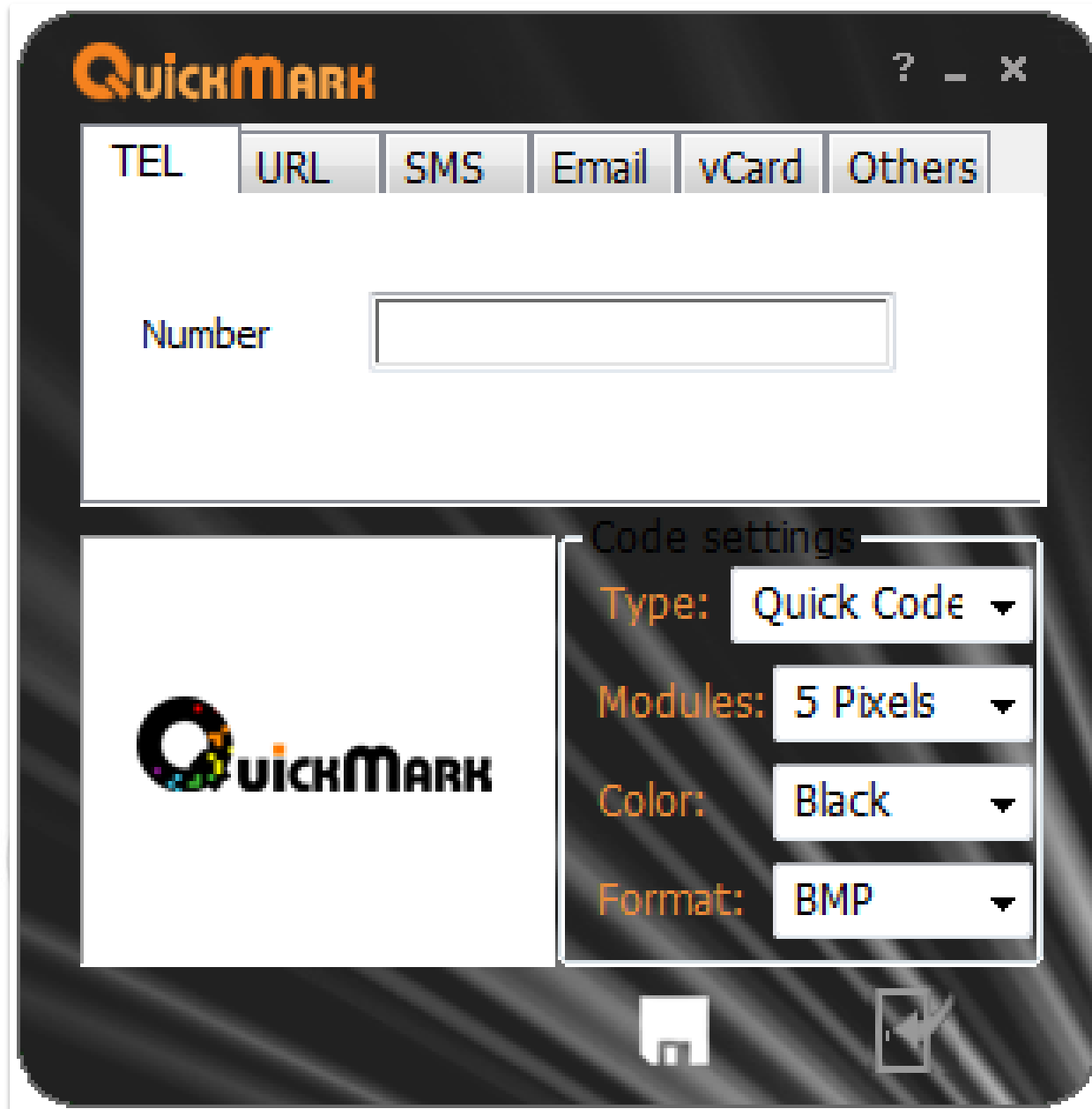

Download i-nigma Reader

Download i-nigma reader The most widely used mobile barcode reader in the world!

Join the 150 million members of the i-nigma global family and revolutionize the way you connect to the mobile internet.

Get ready - check your mobile and your service

With the i-nigma reader installed on your mobile, you will be ready to decode mobile barcodes and connect direct to the mobile internet. To find out if the i-nigma handset software is available yet for your handset, [click here](#) to check our list of over 250 supported mobiles. Of course you will need internet service from your provider.



**Want More
Information?**

[Contact Us](#) >>

Now get the i-nigma reader - there are 2 easy ways

- 1 On the mobile web** - Go to www.i-nigma.mobi on your mobile. I-nigma will automatically identify your handset type, download and install i-nigma.
- 2 By SMS** - Text the word i-nigma to: +44 7797 882325 (or 07797 882325 in the UK). You will receive back an SMS containing a link to the i-nigma software download site.

[Click here to see if your device is supported](#)

* The i-nigma software and services are free for personal use. By downloading or installing i-nigma you automatically accept the [terms of use](#). Please [contact us](#) if you want to use the i-nigma software in a commercial way.

Accomplishment

Assess

Engaged

Learners have open access to interactive content at any time from anywhere.



Learners have ready access to the contextualised content they need when they need it.

Content

Action

Awareness

Scape

Denotes a pictorial representation of a scene or view, as specified by an initial element:

Sea-scape, land-scape, media-scape.



Internal-Scape

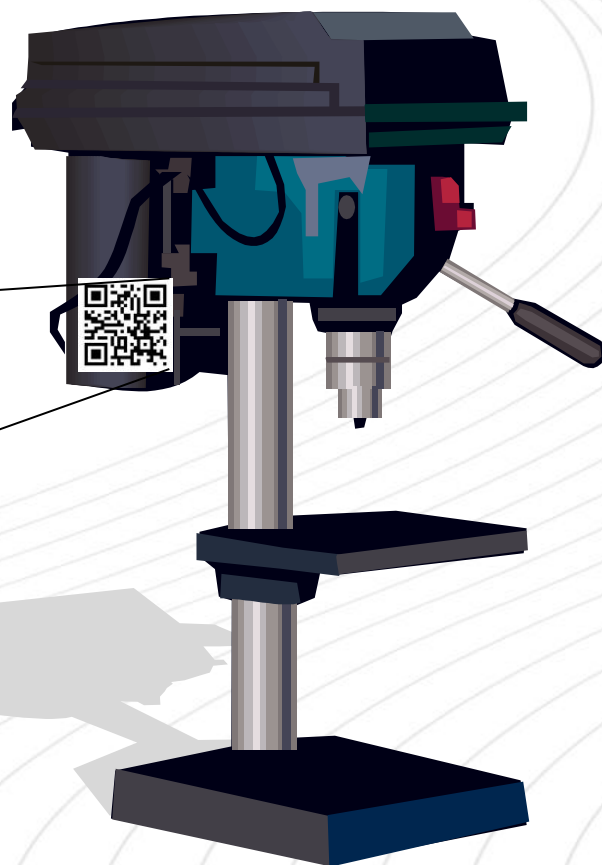

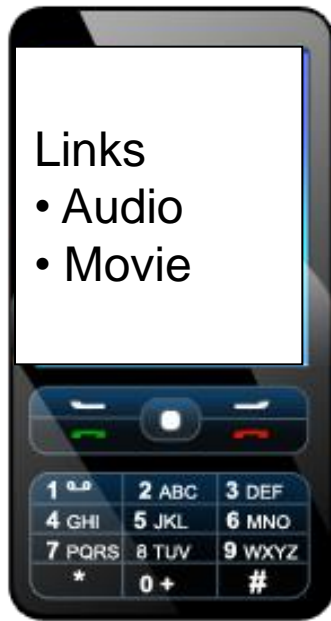

External-Scape



Accomplishment

Assess

Empowered

Participants are competent, confident and capable of using QR/MT.



Ongoing support in QR/MT learning applications provided to learners and tutors.

Capability

Action

Awareness

 [Start](#) |  [Login](#)

 **MLE-Moodle**

Please log-in!

 [Login](#)

 [MLE install \(phone software\)](#)

Powered by [MLE-Moodle](#)



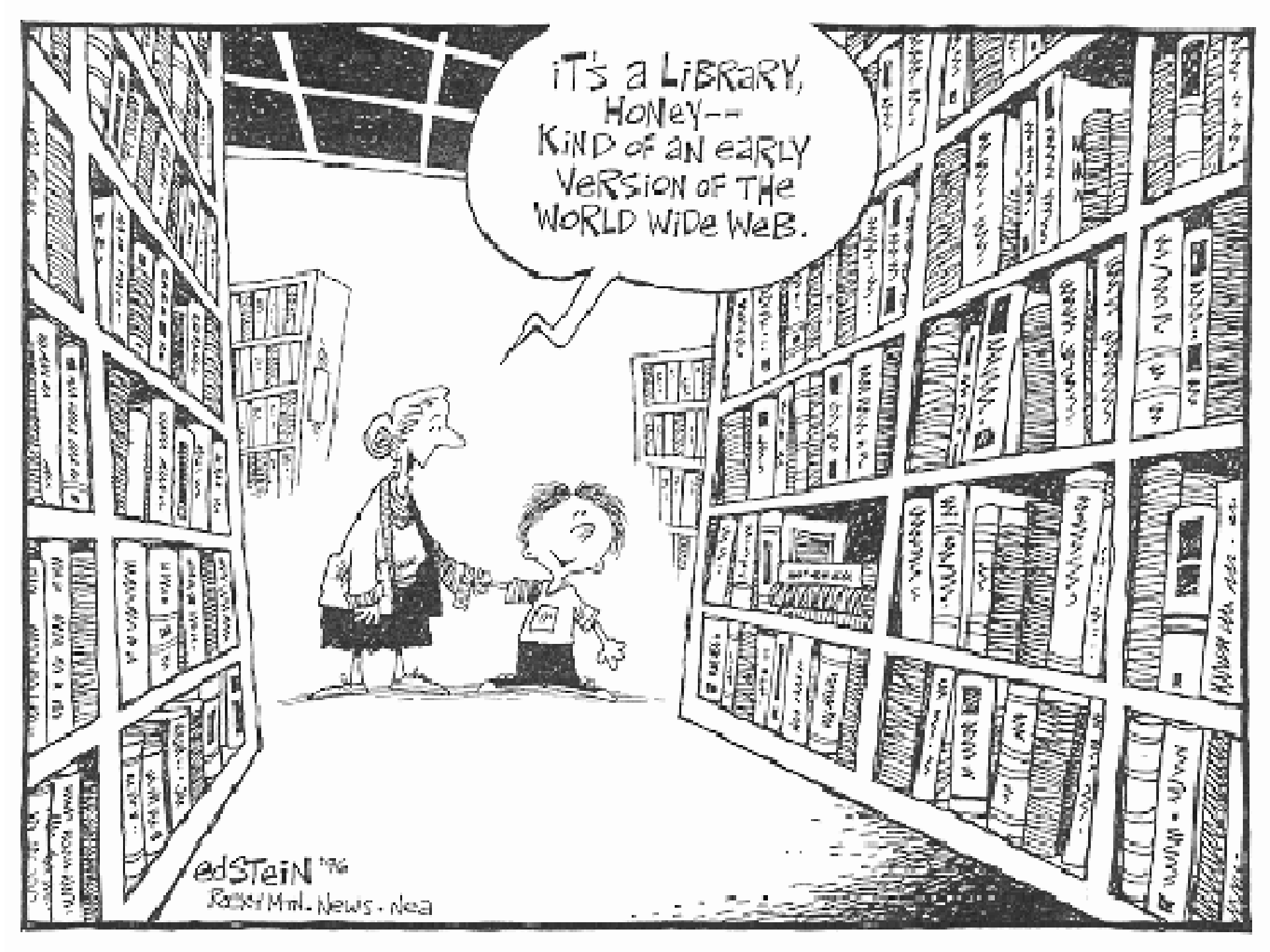

IT'S A LIBRARY,
Honey--
KIND OF AN EARLY
VERSION OF THE
WORLD WIDE WEB.

edStein™

Rocky Mtn. News • Deca

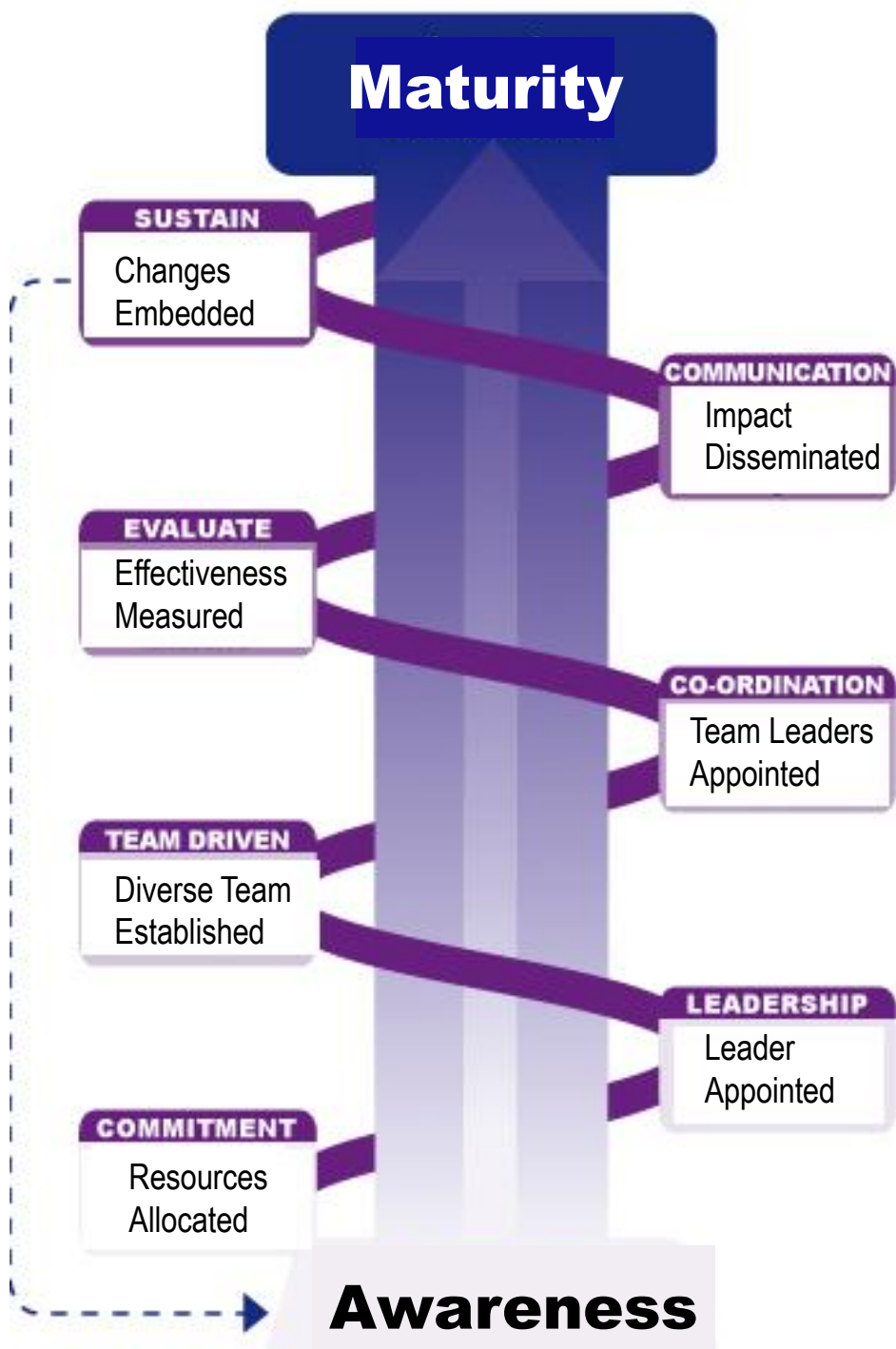

Project review provides best-evidence case study for future developments in OFNL

Leader reports on progress

Progress measured

Team leaders, for the 3Cs, appointed

Internal **and** external teams created and communication channels between teams opened. (Capability needs in OFNL of all team members (internal /external) assessed

Recognised curriculum leader, appointed to lead initiative.

Contestable funding available for developments in OFNL

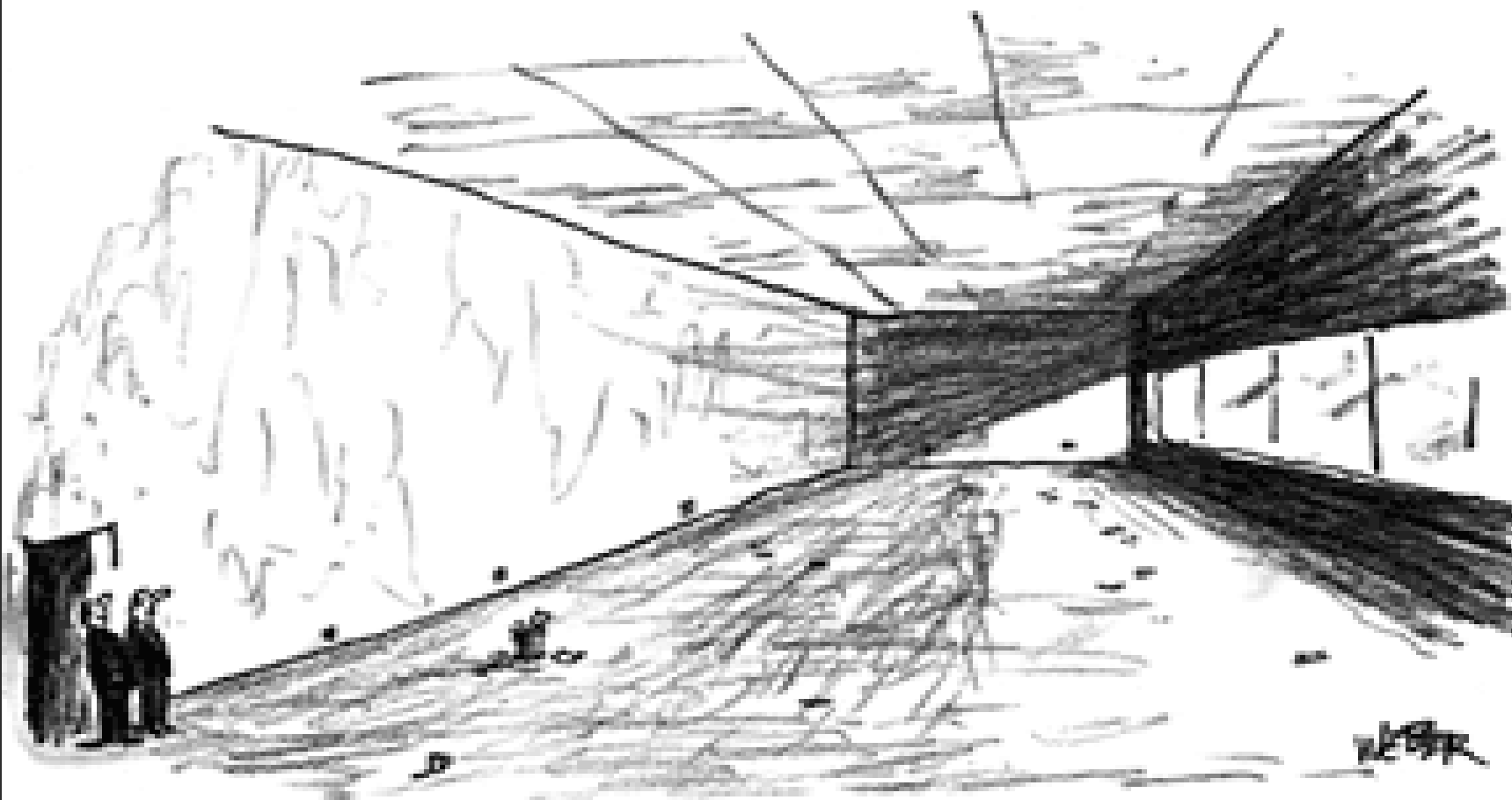

“Well, that does it Charlie—we’ve outsourced everything.”

Questions

Ki te whakakaha i te iwi mā te ara mātauranga, te rangahau umanga whanakenga hoki



Wintec
WAIKATO INSTITUTE OF TECHNOLOGY
Te Kuratini o Waikato